

IRVING A. ROBBINS MIDDLE SCHOOL

20 WOLF PIT ROAD
FARMINGTON, CT 06032

ABATEMENT & FLOORING REPLACEMENT

ARCHITECTS PROJECT NO. 2025-015A

MARCH 27, 2026

ARCHITECT

FRIAR ARCHITECTURE
21 TALCOTT NOTCH ROAD
FARMINGTON, CONNECTICUT 06032

ENVIRONMENTAL ENGINEERS

EAGLE ENVIRONMENTAL, INC.
8 SOUTH MAIN STREET, SUITE 3
TERRYVILLE, CT 06786

SUPERINTENDENT OF SCHOOLS

JESS M. GIANNINI

INDEX OF DRAWINGS

COVER SHEET
HAZARDOUS MATERIAL
HM-1 FIRST FLOOR ABATEMENT PLAN
ARCHITECTURAL
A1.1 FINISH PLAN- AREA A
A1.2 FINISH PLAN- AREA B
A1.3 FINISH PLAN- AREA C
A1.4 FINISH PLAN- AREA D



SITE LOCATION MAP

SET NUMBER

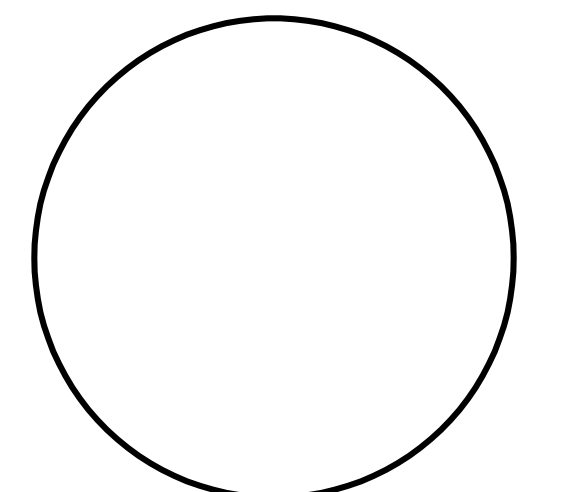

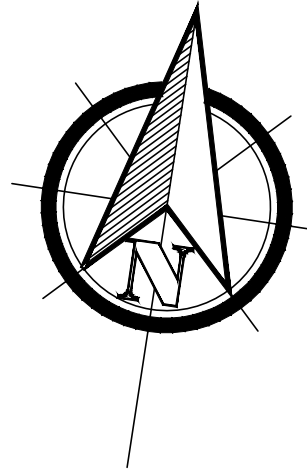

SIDE C

- PHASING KEY:**
- PHASE 1
 - PHASE 2
 - PHASE 3A
 - PHASE 3B

- ABATEMENT KEY:**
- REMOVE AND DISPOSE OF ALL LAYERS OF FLOORING TO CONCRETE SLAB INCLUDING FLOOR LEVELERS AND BOTTOM LAYER OF ASBESTOS-CONTAINING FLOOR TILE AND ADHESIVE.
 - REMOVE AND DISPOSE OF ALL LAYERS OF FLOORING TO CONCRETE SLAB INCLUDING CARPET AND BOTTOM LAYER OF ASBESTOS-CONTAINING FLOOR TILE AND ADHESIVE.
 - REMOVE AND DISPOSE OF ALL FRIABLE ASBESTOS-CONTAINING MUDDED PIPE FITTING CEMENT ABOVE SUSPENDED ACOUSTICAL CEILING SYSTEM.

DATE: 01/27/2025
 DRAWN BY: BB
 SCALE: AS NOTED
 REVIEWED BY: PE
 PROJECT NO.: 25032101

NO.	DATE	DESCRIPTION

ASBESTOS-CONTAINING MATERIAL ABATEMENT FLOOR REPLACEMENT

PROJECT TITLE:
 FARMINGTON P.S.
 IRVING A. ROBBINS MIDDLE SCHOOL
 20 WOLF PIT ROAD
 FARMINGTON, CONNECTICUT 06032

CONSULTANT'S SEAL



FIRST FLOOR ABATEMENT PLAN

SHEET NO. HM-1
 SHEET 1 OF 1

SIDE B

SIDE D

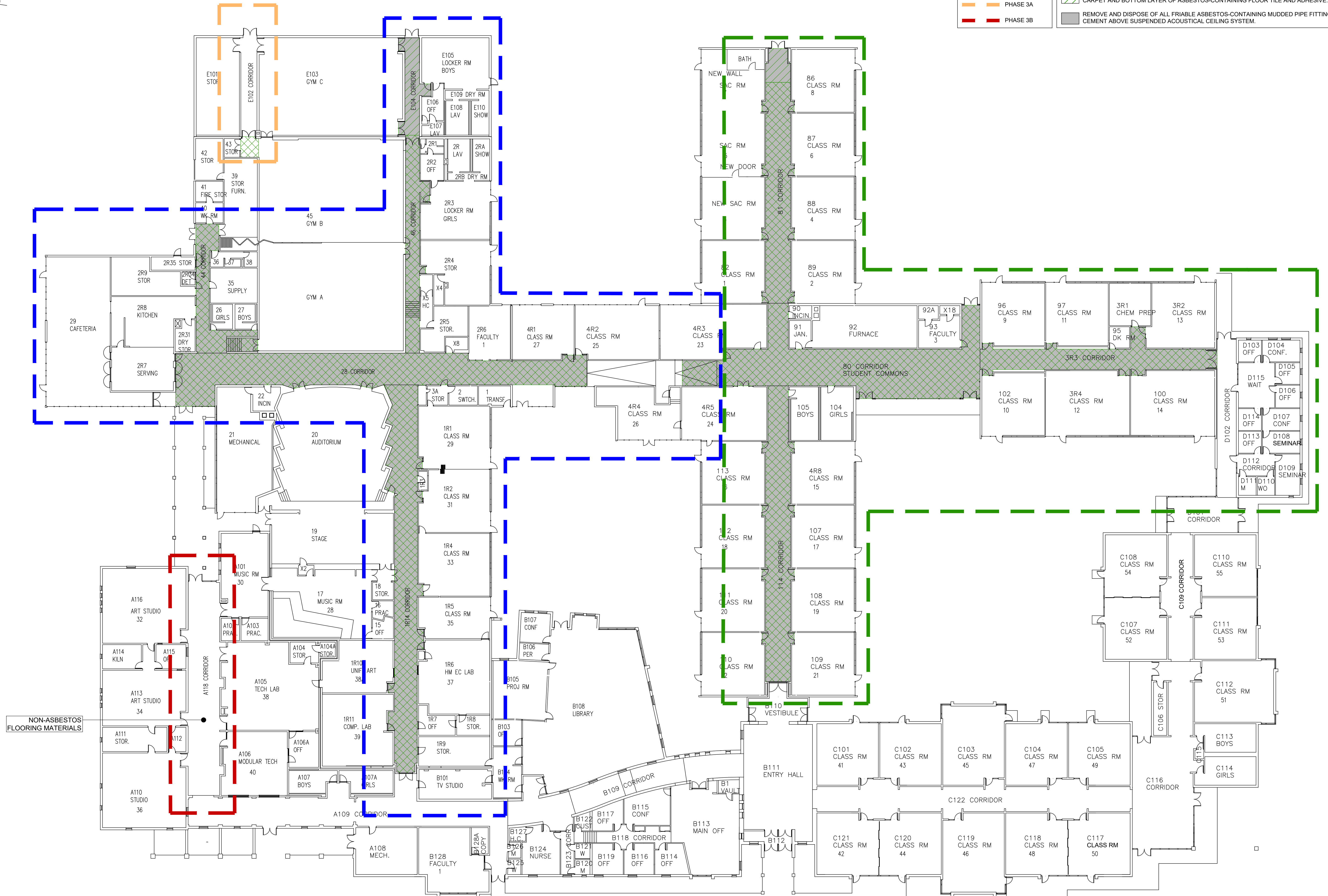

FIRST FLOOR ABATEMENT PLAN
 SCALE: 1" = 20'

SIDE A (STREET SIDE)

- GENERAL NOTES**
- INSTALL TR-1 AT ALL LOCATIONS WHERE NEW ENTRY CARPET TRANSITIONS TO NEW VINYL TEXTILE COMPOSITE C-1.
 - INSTALL TR-2 AT ALL LOCATIONS WHERE NEW VINYL TEXTILE COMPOSITE TRANSITIONS TO EXISTING VCT, OR LVT.
 - FOR ANY ON SITE CONDITIONS REQUIRING A DIFFERENT TRANSITION PROFILE, PROVIDE APPROPRIATE SCHLUTER PROFILE FOR CONDITION.
 - REPLACE AREAS OF EXISTING RUBBER BASE WITH NEW RUBBER BASE, TYPICAL ALL LOCATIONS. DO NOT INSTALL RUBBER BASE ON BLOCK BASE.
 - SELECTED CONTRACTOR TO SUPPLY SHOW DRAWINGS ILLUSTRATING THEY UNDERSTAND THE LOCATIONS OF FLOORING & TRANSITION TYPES.

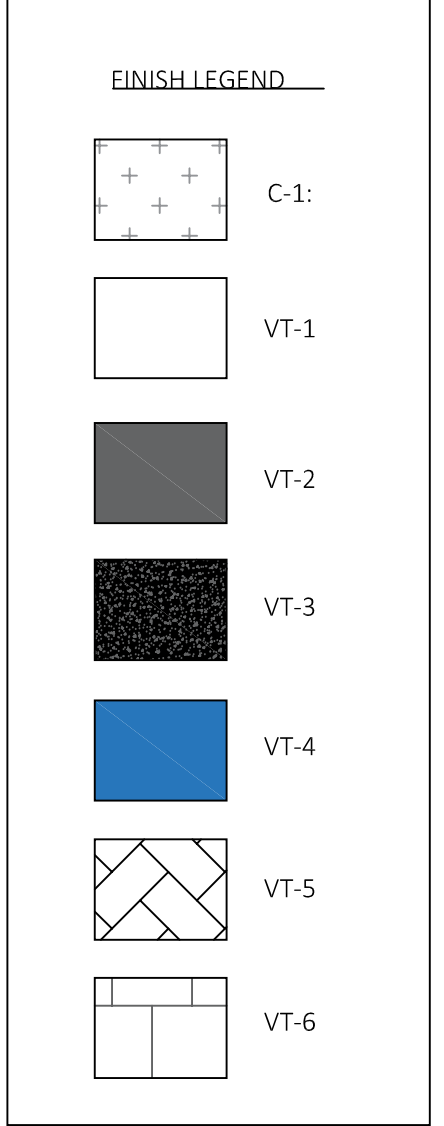

VINYL TEXTILE COMPOSITE		ENTRY CARPET TILE	
VT-1: MANUFACTURER: J & J FLOORING PRODUCT: KINETEX STYLE: NETWORK 1842 COLOR: DATABASE 2851 SIZE: 24" X 24" INSTALL: QUARTER TURN LOCATION: FIELD 1	VT-2: MANUFACTURER: J & J FLOORING PRODUCT: KINETEX STYLE: NETWORK 1842 COLOR: FIREWALL 2852 SIZE: 24" X 24" INSTALL: QUARTER TURN LOCATION: FIELD 2	C-1: MANUFACTURER: SHAW CONTRACT COLLECTION: ALL ACCESS STYLE: PORTAL TILE ST035 COLOR: NAVY 34485 SIZE: 24" X 24" INSTALL: MONOLITHIC LOCATION: ENTRY	TR-1: MANUFACTURER: SCHLUTER SYSTEMS STYLE: SCHIENE COLOR: DARK ANTHRACITE LOCATION: KINETEX TO NEW ENTRY CARPET
VT-3: MANUFACTURER: J & J FLOORING PRODUCT: KINETEX STYLE: NETWORK 1842 COLOR: FABRIC 2917 SIZE: 24" X 24" INSTALL: QUARTER TURN LOCATION: ACCENT 1	VT-4: MANUFACTURER: J & J FLOORING PRODUCT: KINETEX STYLE: NETWORK 1842 COLOR: TRACKS 2909 SIZE: 24" X 24" INSTALL: QUARTER TURN LOCATION: ACCENT 2	TR-2: MANUFACTURER: SCHLUTER SYSTEMS STYLE: VINPRO-S COLOR: TUSCAN PEWTER LOCATION: KINETEX TO EXISTING LVT OR VCT	RUBBER BASE RB-1: MANUFACTURER: JOHNSONITE BY TARKETT STYLE: 4" COVE BASE COLOR: STORM CLOUD 71 LOCATION: ONLY AREAS WITH EXISTING RUBBER BASE.
VT-5: MANUFACTURER: J & J FLOORING PRODUCT: KINETEX STYLE: DIGITAL 1859 COLOR: ZONE 3573 SIZE: 24" X 24" INSTALL: ASHLAR LOCATION: STUDENT COMMONS	VT-6: MANUFACTURER: J & J FLOORING PRODUCT: KINETEX STYLE: CATALYST 1841 COLOR: ACCELERATOR 2846 SIZE: 24" X 24" INSTALL: ASHLAR LOCATION: LOBBYS		

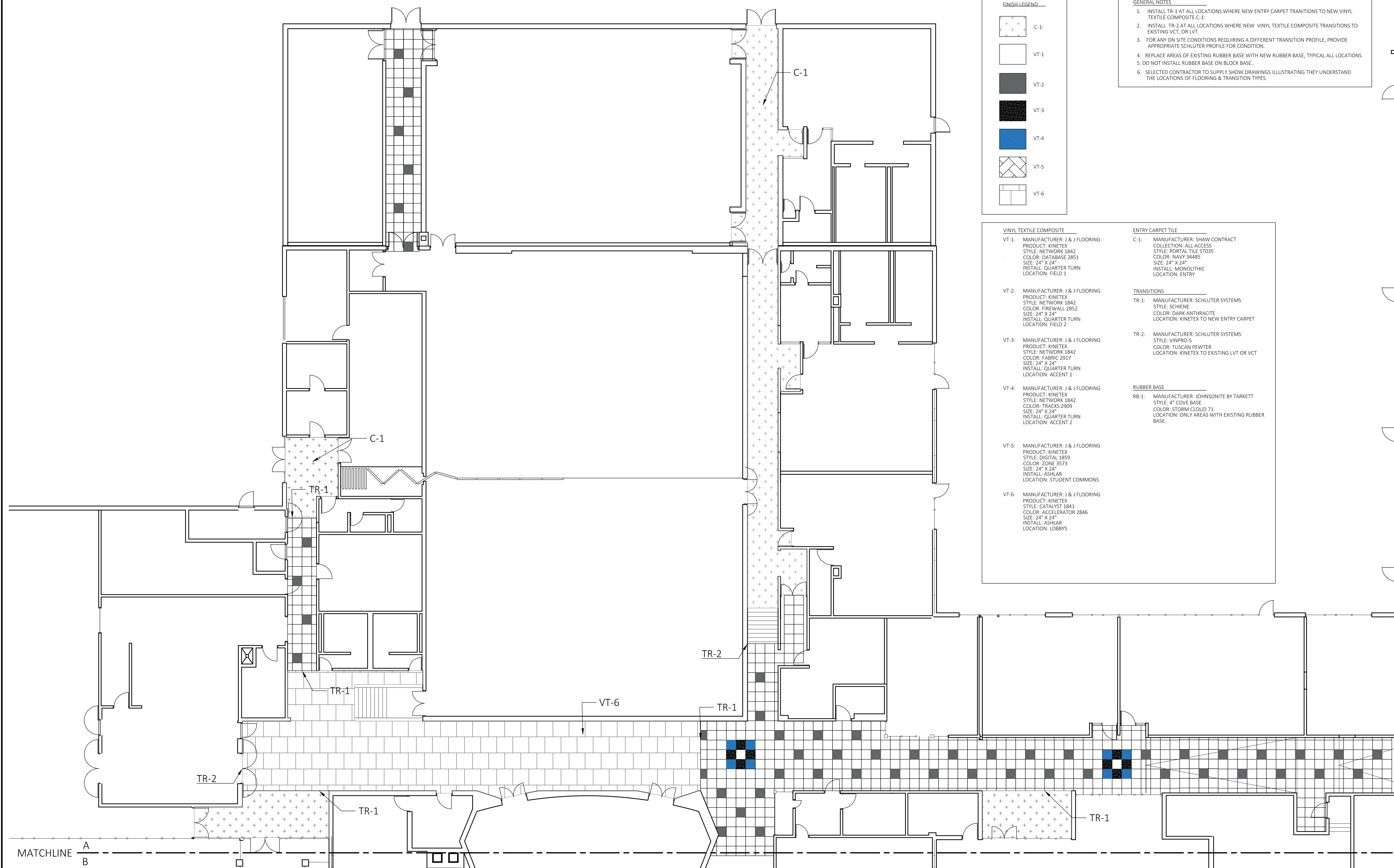

FINISH PLAN - AREA A
SCALE: 1/8"=1'-0"

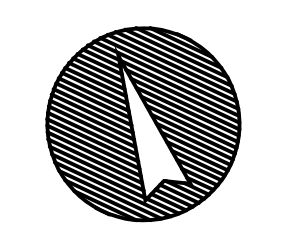
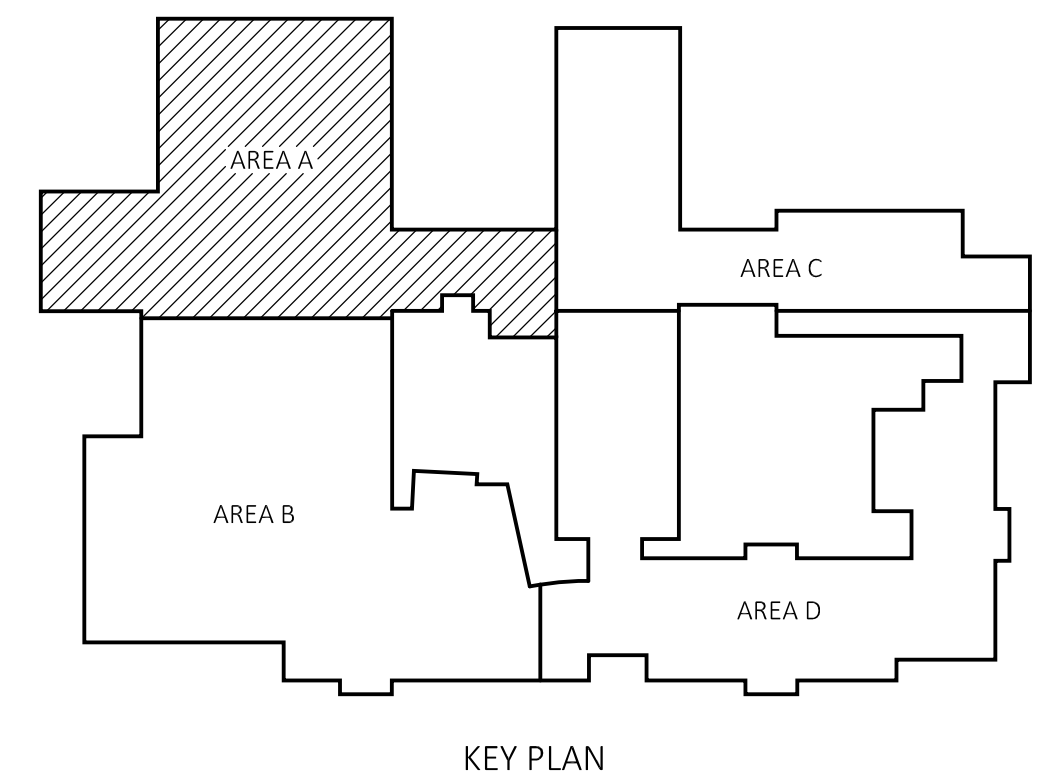

PROFESSIONAL SEAL

CONSULTANT

FLOORING ABATEMENT AND REPLACEMENT
IRVING A. ROBBINS MS

20 WOLF PIT ROAD
FARMINGTON, CT 06032

FRIAR PROJECT NO. 2025-015A

REVISIONS

NO.	DATE	DESCRIPTION

FINISH PLAN AREA A

DATE: 03/27/26
SCALE: 1/8"=1'-0"
PROJ. #: 2025-015A
DRAWN: CMA
CHECKED: CMA





SHEET NO. A1.1

MATCHLINE
A
B

- VINYL TEXTILE COMPOSITE**
- VT-1: MANUFACTURER: J & J FLOORING
PRODUCT: KINETEX
STYLE: NETWORK 1842
COLOR: DATABASE 2851
SIZE: 24" X 24"
INSTALL: QUARTER TURN
LOCATION: FIELD 1
 - VT-2: MANUFACTURER: J & J FLOORING
PRODUCT: KINETEX
STYLE: NETWORK 1842
COLOR: FIREWALL 2852
SIZE: 24" X 24"
INSTALL: QUARTER TURN
LOCATION: FIELD 2
 - VT-3: MANUFACTURER: J & J FLOORING
PRODUCT: KINETEX
STYLE: NETWORK 1842
COLOR: FABRIC 2917
SIZE: 24" X 24"
INSTALL: QUARTER TURN
LOCATION: ACCENT 1
 - VT-4: MANUFACTURER: J & J FLOORING
PRODUCT: KINETEX
STYLE: NETWORK 1842
COLOR: TRACKS 2909
SIZE: 24" X 24"
INSTALL: QUARTER TURN
LOCATION: ACCENT 2
 - VT-4: MANUFACTURER: J & J FLOORING
PRODUCT: KINETEX
STYLE: NETWORK 1842
COLOR: TRACKS 2909
SIZE: 24" X 24"
INSTALL: QUARTER TURN
LOCATION: ACCENT 2
 - VT-5: MANUFACTURER: J & J FLOORING
PRODUCT: KINETEX
STYLE: DIGITAL 1859
COLOR: ZONE 3573
SIZE: 24" X 24"
INSTALL: ASHLAR
LOCATION: STUDENT COMMONS
 - VT-6: MANUFACTURER: J & J FLOORING
PRODUCT: KINETEX
STYLE: CATALYST 1841
COLOR: ACCELERATOR 2846
SIZE: 24" X 24"
INSTALL: ASHLAR
LOCATION: LOBBYS

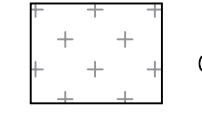
- ENTRY CARPET TILE**
- C-1: MANUFACTURER: SHAW CONTRACT
COLLECTION: ALL ACCESS
STYLE: PORTAL TILE ST035
COLOR: NAVY 34485
SIZE: 24" X 24"
INSTALL: MONOLITHIC
LOCATION: ENTRY
- TRANSITIONS**
- TR-1: MANUFACTURER: SCHLUTER SYSTEMS
STYLE: SCHIENE
COLOR: DARK ANTHRACITE
LOCATION: KINETEX TO NEW ENTRY CARPET
 - TR-2: MANUFACTURER: SCHLUTER SYSTEMS
STYLE: VINPRO-5
COLOR: TUSCAN PEWTER
LOCATION: KINETEX TO EXISTING LVT OR VCT
- RUBBER BASE**
- RB-1: MANUFACTURER: JOHNSONITE BY TARKETT
STYLE: 4" COVE BASE
COLOR: STORM CLOUD 71
LOCATION: ONLY AREAS WITH EXISTING RUBBER BASE.

FINISH LEGEND

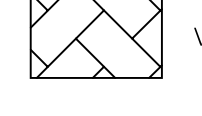
-  C-1
-  VT-1
-  VT-2
-  VT-3
-  VT-4
-  VT-5

- GENERAL NOTES**
1. INSTALL TR-1 AT ALL LOCATIONS WHERE NEW ENTRY CARPET TRANSITIONS TO NEW VINYL TEXTILE COMPOSITE C-1.
 2. INSTALL TR-2 AT ALL LOCATIONS WHERE NEW VINYL TEXTILE COMPOSITE TRANSITIONS TO EXISTING VCT, OR LVT.
 3. FOR ANY ON SITE CONDITIONS REQUIRING A DIFFERENT TRANSITION PROFILE, PROVIDE APPROPRIATE SCHLUTER PROFILE FOR CONDITION.
 4. REPLACE AREAS OF EXISTING RUBBER BASE WITH NEW RUBBER BASE, TYPICAL ALL LOCATIONS.
 5. DO NOT INSTALL RUBBER BASE ON BLOCK BASE.
 6. SELECTED CONTRACTOR TO SUPPLY SHOW DRAWINGS ILLUSTRATING THEY UNDERSTAND THE LOCATIONS OF FLOORING & TRANSITION TYPES.

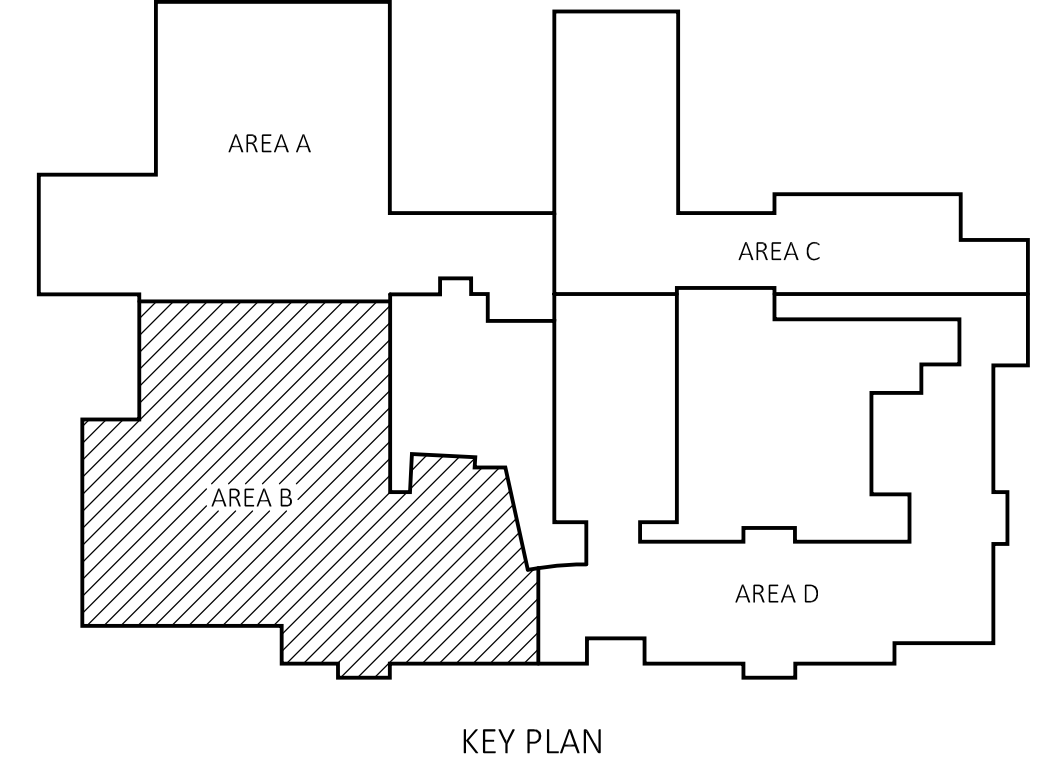

FINISH PLAN - AREA B
SCALE: 1/8"=1'-0"

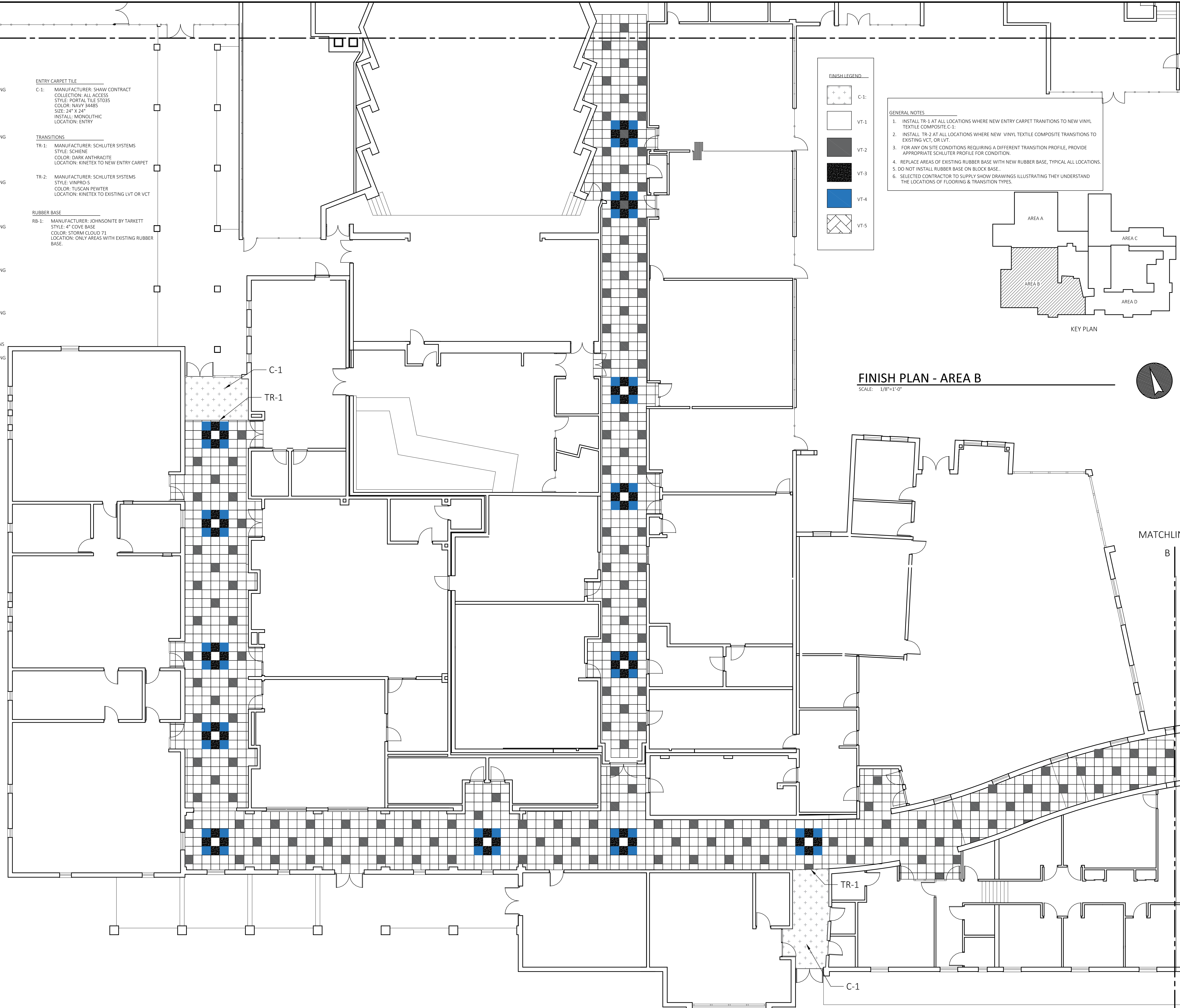
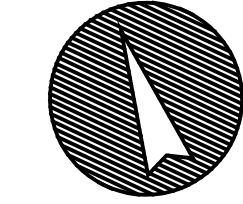

PROFESSIONAL SEAL

CONSULTANT

FLOORING ABATEMENT
AND REPLACEMENT
IRVING A. ROBBINS MS

20 WOLF PIT ROAD
FARMINGTON, CT 06032

FRIAR PROJECT NO. 2025-015A

REVISIONS

NO.	DATE	DESCRIPTION

**FINISH PLAN
AREA B**

DATE: 03/27/26
SCALE: 1/8"=1'-0"
PROJ. #: 2025-015A
DRAWN: CMA
CHECKED: CMA

**SHEET NO.
A1.2**

PROFESSIONAL SEAL

CONSULTANT

FLOORING ABATEMENT AND REPLACEMENT
IRVING A. ROBBINS MS

20 WOLF PIT ROAD
FARMINGTON, CT 06032

FRIAR PROJECT NO. 2025-015A

REVISIONS

NO.	DATE	DESCRIPTION

FINISH PLAN
AREA C

DATE: 03/27/26
SCALE: 1/8"=1'-0"
PROJ. #: 2025-015A
DRAWN: CMA
CHECKED: CMA

SHEET NO.
A1.3

FINISH LEGEND

	C-1
	VT-1
	VT-2
	VT-3
	VT-4
	VT-5

- GENERAL NOTES
- INSTALL TR-1 AT ALL LOCATIONS WHERE NEW ENTRY CARPET TRANSITIONS TO NEW VINYL TEXTILE COMPOSITE C-1.
 - INSTALL TR-2 AT ALL LOCATIONS WHERE NEW VINYL TEXTILE COMPOSITE TRANSITIONS TO EXISTING VCT, OR LVT.
 - FOR ANY ON SITE CONDITIONS REQUIRING A DIFFERENT TRANSITION PROFILE, PROVIDE APPROPRIATE SCHLUTER PROFILE FOR CONDITION.
 - REPLACE AREAS OF EXISTING RUBBER BASE WITH NEW RUBBER BASE, TYPICAL ALL LOCATIONS.
 - DO NOT INSTALL RUBBER BASE ON BLOCK BASE.
 - SELECTED CONTRACTOR TO SUPPLY SHOW DRAWINGS ILLUSTRATING THEY UNDERSTAND THE LOCATIONS OF FLOORING & TRANSITION TYPES.

VINYL TEXTILE COMPOSITE	ENTRY CARPET TILE
VT-1: MANUFACTURER: J & J FLOORING PRODUCT: KINETEX STYLE: NETWORK 1842 COLOR: DATABASE 2851 SIZE: 24" X 24" INSTALL: QUARTER TURN LOCATION: FIELD 1	C-1: MANUFACTURER: SHAW CONTRACT COLLECTION: ALL ACCESS STYLE: PORTAL TILE ST035 COLOR: NAVY 34485 SIZE: 24" X 24" INSTALL: MONOLITHIC LOCATION: ENTRY
VT-2: MANUFACTURER: J & J FLOORING PRODUCT: KINETEX STYLE: NETWORK 1842 COLOR: FIREWALL 2852 SIZE: 24" X 24" INSTALL: QUARTER TURN LOCATION: FIELD 2	TRANSITIONS TR-1: MANUFACTURER: SCHLUTER SYSTEMS STYLE: SCHENE COLOR: DARK ANTHRACITE LOCATION: KINETEX TO NEW ENTRY CARPET
VT-3: MANUFACTURER: J & J FLOORING PRODUCT: KINETEX STYLE: NETWORK 1842 COLOR: FABRIC 2917 SIZE: 24" X 24" INSTALL: QUARTER TURN LOCATION: ACCENT 1	TR-2: MANUFACTURER: SCHLUTER SYSTEMS STYLE: VINPRO-S COLOR: TUSCAN PEWTER LOCATION: KINETEX TO EXISTING LVT OR VCT
VT-4: MANUFACTURER: J & J FLOORING PRODUCT: KINETEX STYLE: NETWORK 1842 COLOR: TRACKS 2909 SIZE: 24" X 24" INSTALL: QUARTER TURN LOCATION: ACCENT 2	RUBBER BASE RB-1: MANUFACTURER: JOHNSONITE BY TARKETT STYLE: 4" COVE BASE COLOR: STORM CLOUD 71 LOCATION: ONLY AREAS WITH EXISTING RUBBER BASE.
VT-4: MANUFACTURER: J & J FLOORING PRODUCT: KINETEX STYLE: NETWORK 1842 COLOR: TRACKS 2909 SIZE: 24" X 24" INSTALL: QUARTER TURN LOCATION: ACCENT 2	
VT-5: MANUFACTURER: J & J FLOORING PRODUCT: KINETEX STYLE: DIGITAL 1859 COLOR: ZONE 3573 SIZE: 24" X 24" INSTALL: ASHLAR LOCATION: STUDENT COMMONS	
VT-6: MANUFACTURER: J & J FLOORING PRODUCT: KINETEX STYLE: CATALYST 1841 COLOR: ACCELERATOR 2846 SIZE: 24" X 24" INSTALL: ASHLAR LOCATION: LOBBYS	

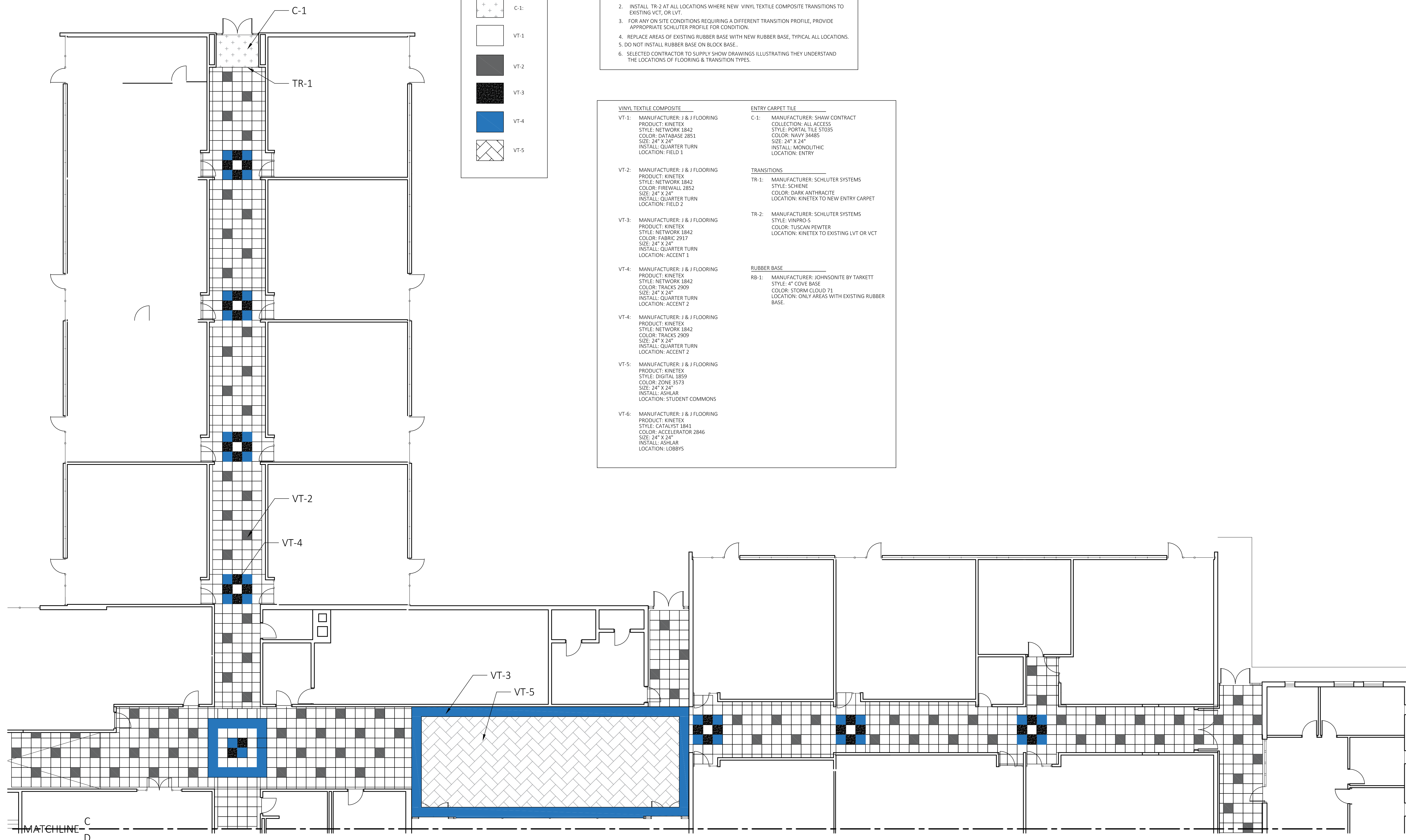

FINISH PLAN - AREA C

SCALE: 1/8"=1'-0"

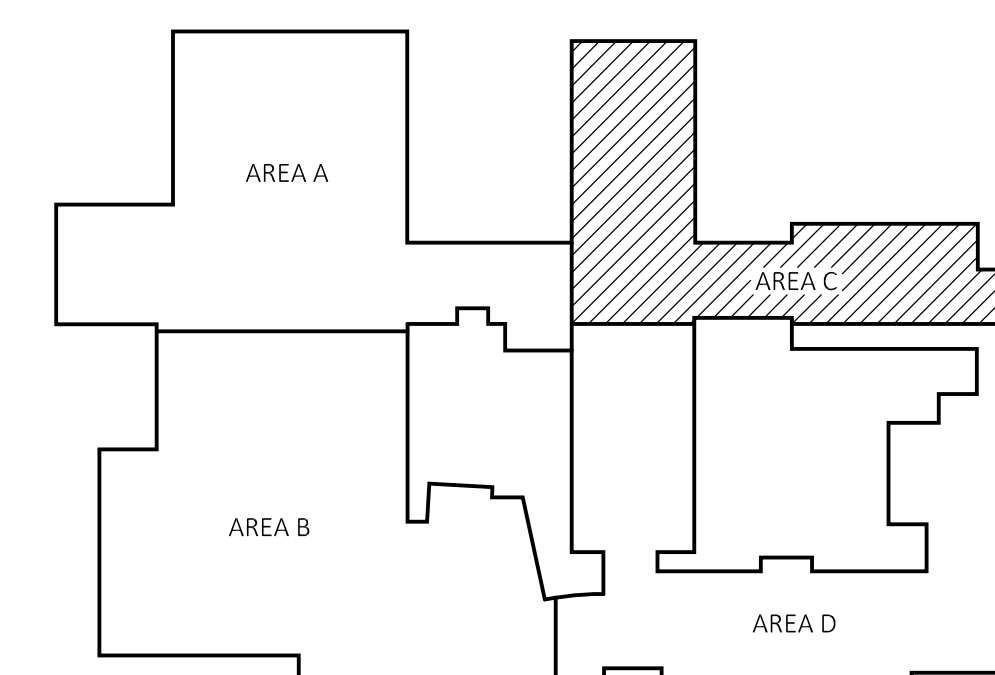

KEY PLAN



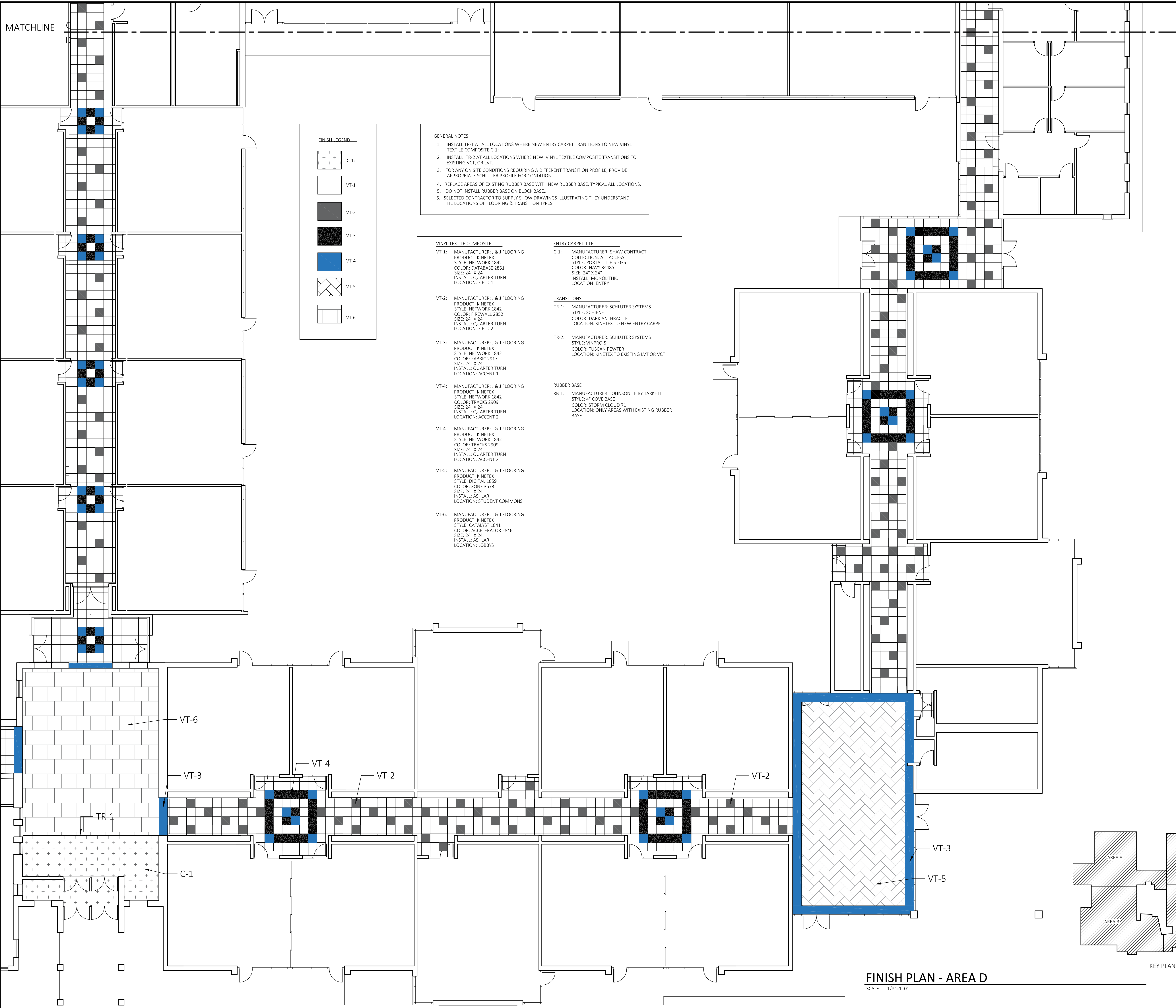

FINISH LEGEND

	C-1:
	VT-1:
	VT-2:
	VT-3:
	VT-4:
	VT-5:
	VT-6:

- GENERAL NOTES**
1. INSTALL TR-1 AT ALL LOCATIONS WHERE NEW ENTRY CARPET TRANSITIONS TO NEW VINYL TEXTILE COMPOSITE C-1.
 2. INSTALL TR-2 AT ALL LOCATIONS WHERE NEW VINYL TEXTILE COMPOSITE TRANSITIONS TO EXISTING VCT, OR LVT.
 3. FOR ANY ON SITE CONDITIONS REQUIRING A DIFFERENT TRANSITION PROFILE, PROVIDE APPROPRIATE SCHLUTER PROFILE FOR CONDITION.
 4. REPLACE AREAS OF EXISTING RUBBER BASE WITH NEW RUBBER BASE, TYPICAL ALL LOCATIONS.
 5. DO NOT INSTALL RUBBER BASE ON BLOCK BASE.
 6. SELECTED CONTRACTOR TO SUPPLY SHOW DRAWINGS ILLUSTRATING THEY UNDERSTAND THE LOCATIONS OF FLOORING & TRANSITION TYPES.

VINYL TEXTILE COMPOSITE	ENTRY CARPET TILE
VT-1: MANUFACTURER: J & J FLOORING PRODUCT: KINETEX STYLE: NETWORK 1842 COLOR: DATABASE 2851 SIZE: 24" X 24" INSTALL: QUARTER TURN LOCATION: FIELD 1	C-1: MANUFACTURER: SHAW CONTRACT COLLECTION: ALL ACCESS STYLE: PORTAL TILE ST035 COLOR: NAVY 34495 SIZE: 24" X 24" INSTALL: MONOLITHIC LOCATION: ENTRY
VT-2: MANUFACTURER: J & J FLOORING PRODUCT: KINETEX STYLE: NETWORK 1842 COLOR: FIREWALL 2852 SIZE: 24" X 24" INSTALL: QUARTER TURN LOCATION: FIELD 2	TRANSITIONS TR-1: MANUFACTURER: SCHLUTER SYSTEMS STYLE: SCHIENE COLOR: DARK ANTHRACITE LOCATION: KINETEX TO NEW ENTRY CARPET TR-2: MANUFACTURER: SCHLUTER SYSTEMS STYLE: VINPRO-5 COLOR: TUSCAN PEWTER LOCATION: KINETEX TO EXISTING LVT OR VCT
VT-3: MANUFACTURER: J & J FLOORING PRODUCT: KINETEX STYLE: NETWORK 1842 COLOR: FABRIC 2917 SIZE: 24" X 24" INSTALL: QUARTER TURN LOCATION: ACCENT 1	RUBBER BASE RB-1: MANUFACTURER: JOHNSONITE BY TARKETT STYLE: 4" COVE BASE COLOR: STORM CLOUD 71 LOCATION: ONLY AREAS WITH EXISTING RUBBER BASE.
VT-4: MANUFACTURER: J & J FLOORING PRODUCT: KINETEX STYLE: NETWORK 1842 COLOR: TRACKS 2909 SIZE: 24" X 24" INSTALL: QUARTER TURN LOCATION: ACCENT 2	
VT-4: MANUFACTURER: J & J FLOORING PRODUCT: KINETEX STYLE: NETWORK 1842 COLOR: TRACKS 2909 SIZE: 24" X 24" INSTALL: QUARTER TURN LOCATION: ACCENT 2	
VT-5: MANUFACTURER: J & J FLOORING PRODUCT: KINETEX STYLE: DIGITAL 1859 COLOR: ZONE 3573 SIZE: 24" X 24" INSTALL: ASHLAR LOCATION: STUDENT COMMONS	
VT-6: MANUFACTURER: J & J FLOORING PRODUCT: KINETEX STYLE: CATALYST 1841 COLOR: ACCELERATOR 2846 SIZE: 24" X 24" INSTALL: ASHLAR LOCATION: LOBBYS	

PROFESSIONAL SEAL

CONSULTANT

FLOORING ABATEMENT AND REPLACEMENT
IRVING A. ROBBINS MS

20 WOLF PIT ROAD
 FARMINGTON, CT 06032

FRIAR PROJECT NO. 2025-015A

REVISIONS

NO.	DATE	DESCRIPTION

FINISH PLAN AREA D

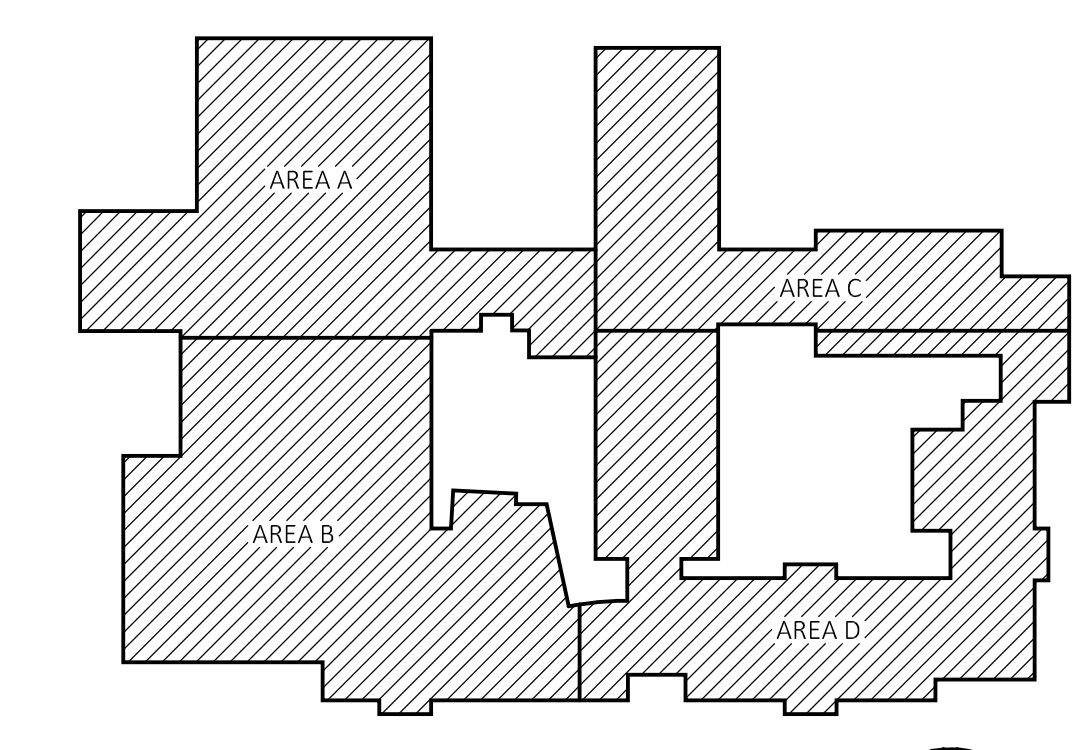

FINISH PLAN - AREA D
 SCALE: 1/8"=1'-0"

